

Felix

Assembly Instructions

KING[®]
L I V I N G

Two people are required for safe assembly.

Opening Box

DO NOT use a knife to cut this box open.

Simply pull the tape from one end of the box to the other to open.

To assemble your furniture please follow the steps below.

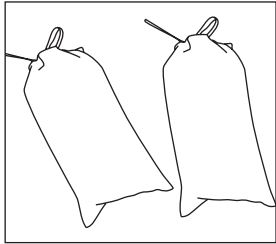

1a

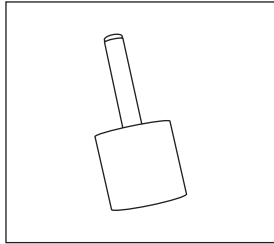

1b 4x Legs per platform.
6x Legs per 3 Seater

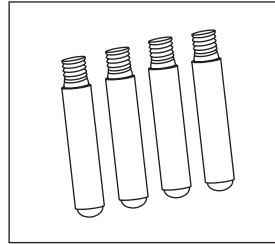

1c 4x per Platform.
6x per 3 Seater.

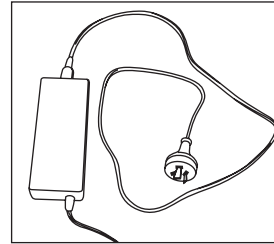

1d 1x per electric seat.

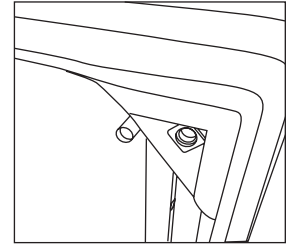

2

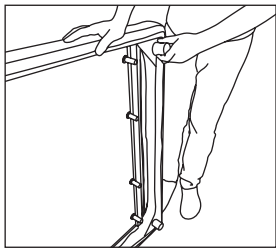

3 Attach Legs.

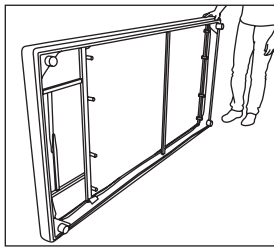

4

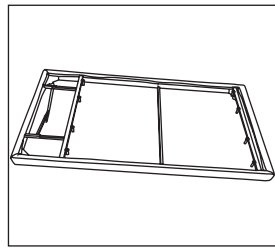

5

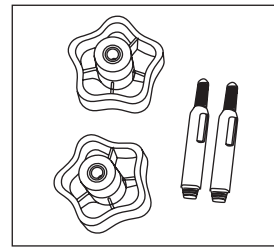

6 Attach to Back Panels.

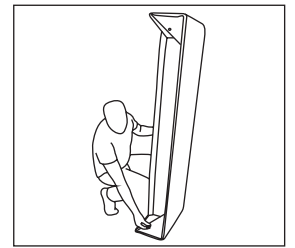

7

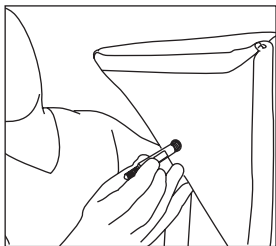

8

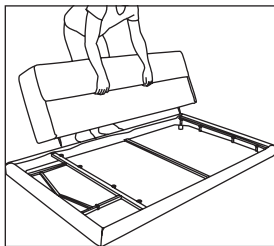

9

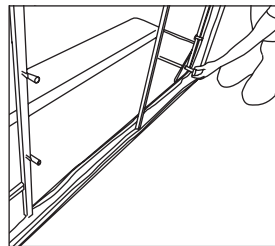

10

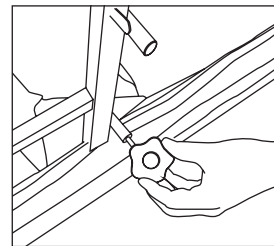

11

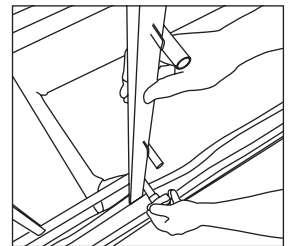

12

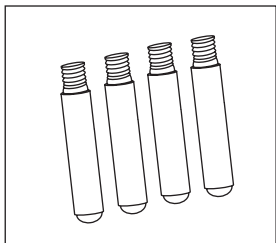

13 4x per Platform.
6x per 3 Seater.

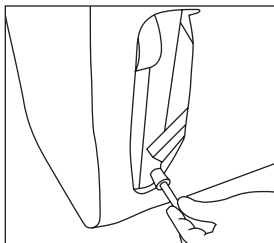

14

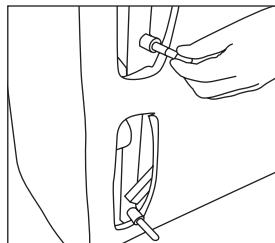

15

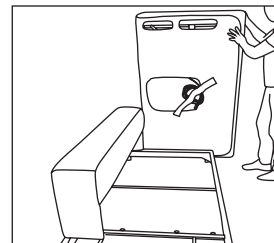

16

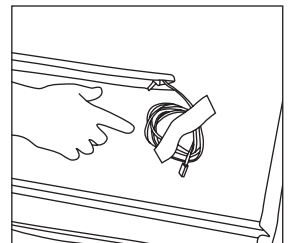

17 Release cable.

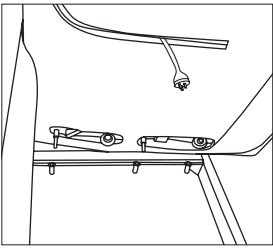

18

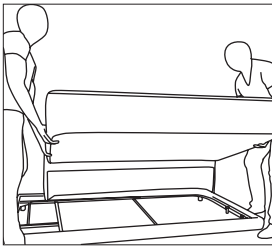

19

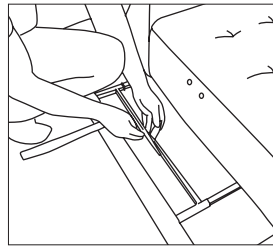

20

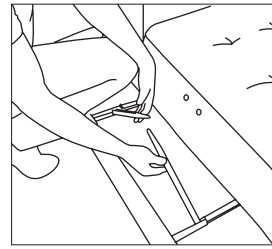

21

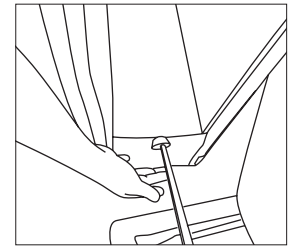

22

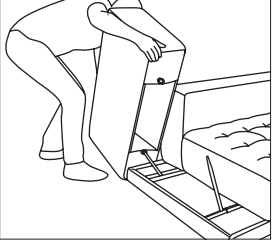

23

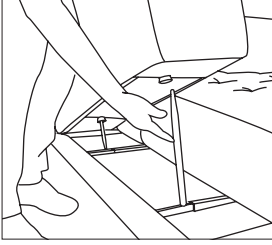

24



25



26



27